



Number Plate

(Part #715003943) (Instruction #487802359)

DISCLAIMER

The purchaser understands, recognizes, and agrees that the suitability of any part sold or manufactured by Lone Star Racing for a particular application is the purchaser's decision and that the purchaser is not relying on the skill or judgment of Lone Star Racing regarding suitability of any product or service. Prices and product designs are subject to change without notice. All parts manufactured by Lone Star Racing have a one year limited warranty against defects in material and workmanship. Liability is limited to repair or replacement of the defective parts to the original purchaser only. This warranty shall not apply to any product which has been repaired or altered in any way so as in our judgment to affect its performance, including those parts that have been subject to misuse, abuse, negligence or any other occurrence beyond the control of Lone Star Racing. Lone Star Racing reserves the right to determine if claims are legitimate. We do not warranty moving parts such as ball joints, bearings, or bushings. Lone Star Racing is not liable for consequential damage or injury due to the use or misuse of any product built or sold by Lone Star Racing.

The illustrations in this document show typical construction of the different assemblies and may not reproduce the full detail or exact shape of the parts: however, they represent parts that have the same or similar function.

WARNING

- **This instruction sheet MUST be given to the purchaser.**
- Read and understand these instructions before installing product
- This product does not provide additional roll over protection
- This product is not intended as an anchor point for pulling
- Do not use product if there are any signs of damage
- For safety reasons, this kit must be installed by an authorized BRP dealer.
- This kit is designed for specific applicable models only (authorized BRP dealers will confirm model(s)). It is not recommended for units other than the one (those) for which it was sold.
- Torque wrench tightening specifications must strictly be adhered to.
- Should removal of a locking device (e.g. lock tabs, self-locking fasteners, etc.) be required when undergoing disassembly/assembly, always replace with a new one.
- Some components may be HOT. Always wait for engine to cool down before performing work.
- Always wear EYE PROTECTION AND APPROPRIATE GLOVES when using power tools.
- Unless otherwise specified, engine must be OFF when performing any operation on the vehicle.
- Always be aware of parts that can move, such as wheels, transmission components, etc.

Installation time is approximately .5 hours



Parts Included:

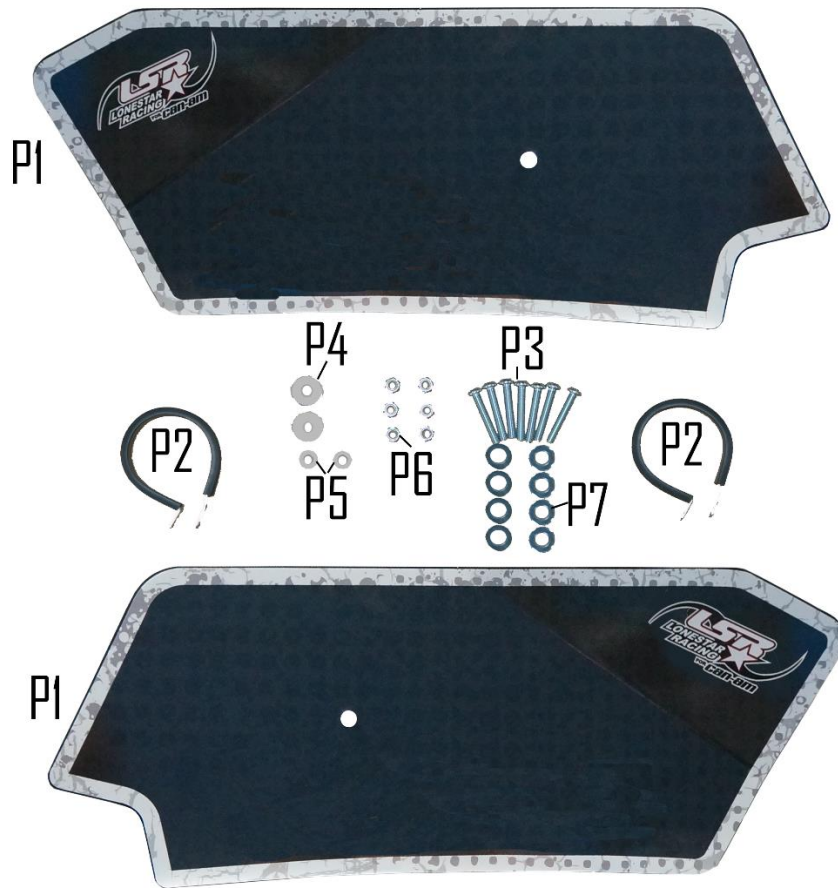

<u>#</u>	<u>Description</u>	<u>Quantity</u>
P1	Number Plates	2
P2	Roll Cage Clamps	2
P3	M6x1.0x30 Bolts	6
P4	Billet Spacers	2
P5	M6 Small Flat Washers	2
P6	M6x1.0 Nylon Locknuts	6
P7	M6 Large Flat Washers	8



Tools needed:

- 10mm socket
- 4mm allen wrench
- 30 TORX bit

Installation:

1. Remove two factory bolts.(fig 1-1)

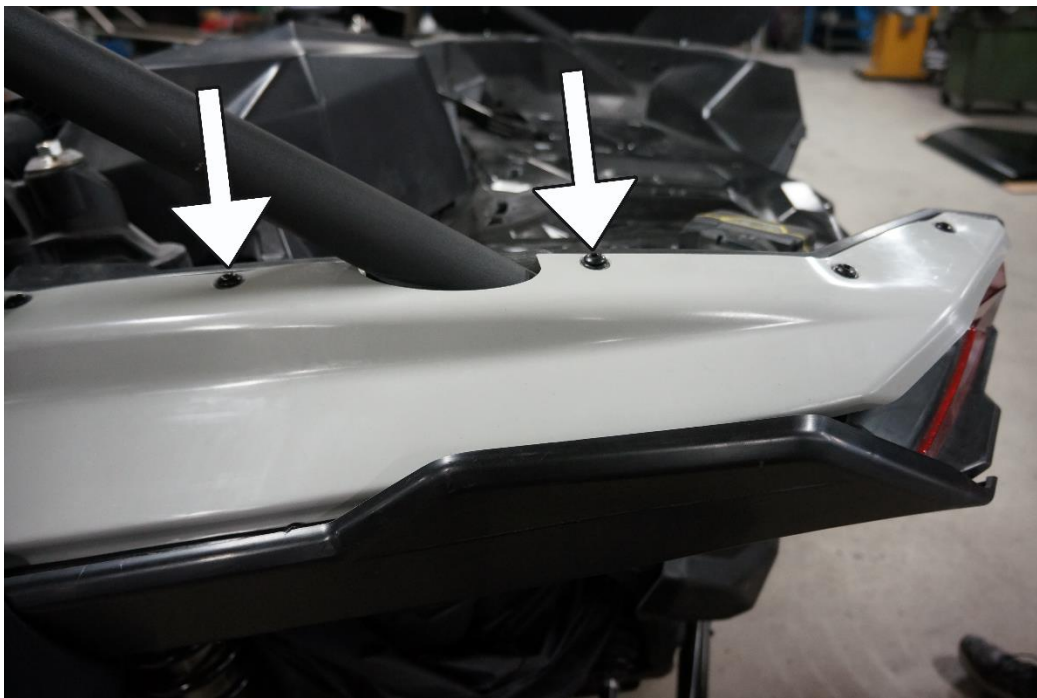

Figure 1-1

2. Set number plate in place and attach by using an M6x1.0x30 bolt with an M6 large washer on top and on bottom of plastics with an M6 nylon locknut on bottom. Hand tighten only at this time.(fig. 2-1)

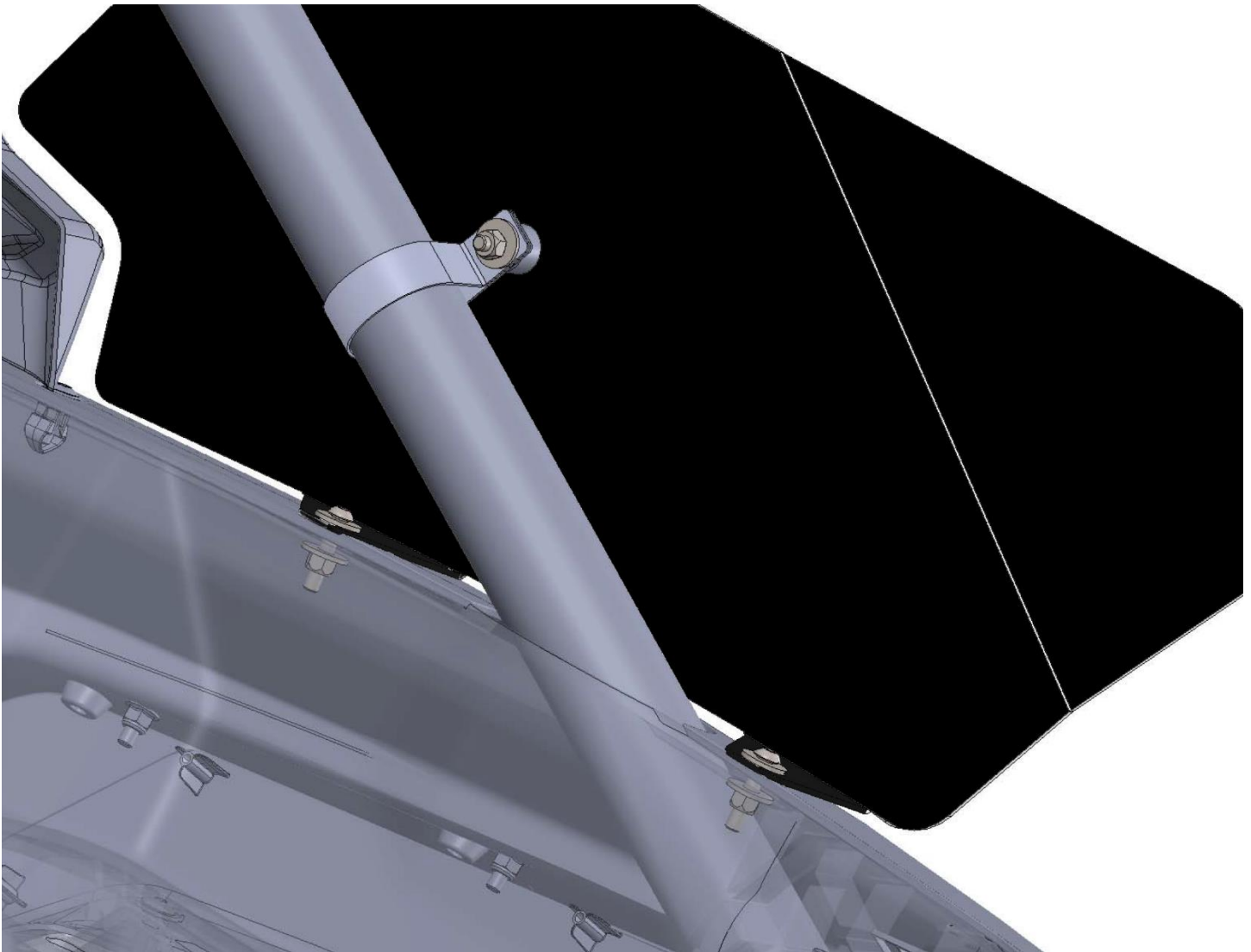

Figure 2-1

3. Attach roll cage clamp to roll cage and bolt up to number plate by inserting the M6 bolt and M6 small washer through the number plate, through the billet spacer, through the clamp and attach using a M6 large washer and M6 nylon locknut. Torque to 18 lb. in.(fig 3-1)

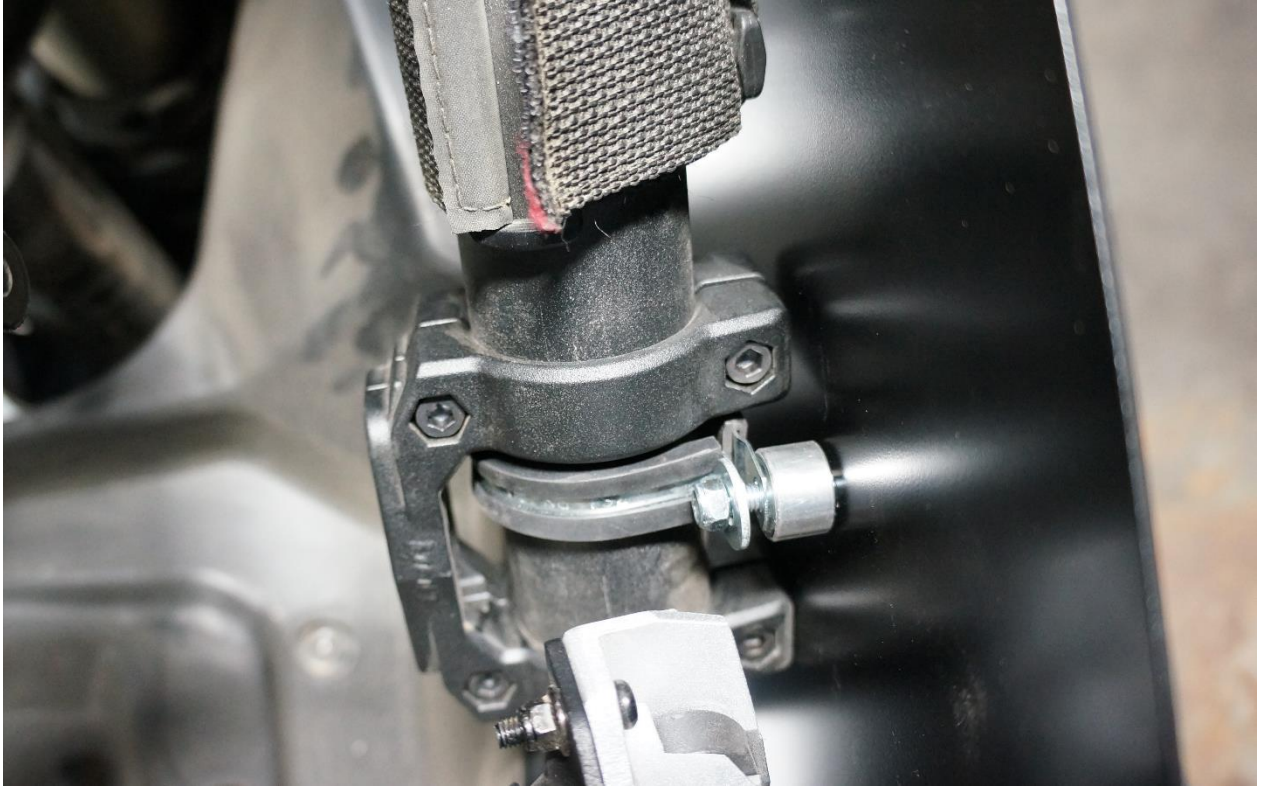

Figure 3-1

4. Torque remaining bolts to 18 lb. in.